



CLIMATE CONTROL SYSTEMS

**ELECTRICALLY HEATED ROLLER KILN
MOD. TR 18/4X33/10-E 90**

GENERAL INFORMATION

- Electrically heated roller kiln Mod. TR 18/4x33/10-E 90
- Condition: as new
- Offer for immediate sale

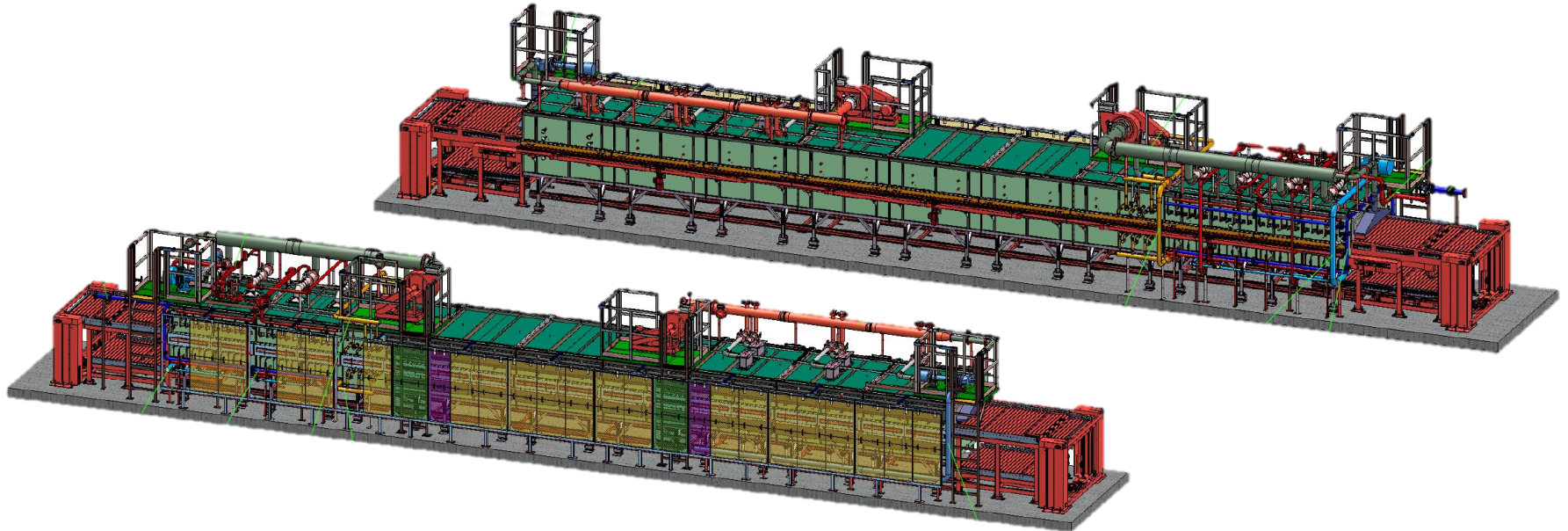

SPECIFICATIONS

The kiln is an electrically heated roller kiln. The product is mechanically transported through the kiln on a roller conveyor.

The kiln is designed in such a way that no special foundation is required. The usual concreted, screeded flat hall floor is sufficient.

The dimensions of the sections of the plant, which consists of heating, sintering and cooling zones, are adapted to the requirements of the temperature curve.

Temperatures and pressures in the kiln are controlled automatically.

The kiln casings are modular. Each housing is lined with different bricks, which are optimally adapted to the different temperature requirements in the respective zones.

This optimal wall construction achieves a low heat emission to the outside.

Technical data		
Debinding zone length	6,12	m
Length of the heating/holding zone	6,12	m
Length of the cooling zone	6,12	m
Total length of kiln without conveyor system approx.	18,4	m
Total length kiln with inlet / outlet	20,4	m
Total width kiln without space for maintenance approx.	3,5	m
Total height kiln approx.	2,5	m
Clear kiln width	1.540	mm
Useable width	4x 330	mm
Useful height from top edge of roller	100	mm
Roller distance approx.	85	mm
Roller outer diameter approx.	50	mm
Number of drives kiln conveyor (controlled)	3	pcs.
Heating	electrical	
Number of control groups	34	
Connected power kiln approx.	476	kW
Maximum temperature at thermocouple	900	°C
Safety shutdown temperature of the kiln	930	°C
Current type	400/230 50	V Hz
Cooling water consumption approx.	50	m³/h

FURTHER INFORMATION

KILN ZONES

The exhaust ports are located on the ceiling of the kiln and can be adjusted manually.

The exhaust gas is led to a collecting pipe, post-combusted in a TNV (not included in the scope of delivery) and mixed with fresh air to lower the temperature. An induced draft fan conveys the flue gases to an on-site chimney, which is not included.

The kiln is equipped with wire heating coils, which are installed above and below the roller level.

The temperature of each control group is controlled by the PLC. Due to the high accuracy, a high control quality is achieved.

The cooling zone is equipped with appropriate connections for direct and indirect air or water cooling.

HOUSING

The housings with a module length of approx. 1 m are made of a solid steel construction frame and are welded with corresponding metal sheets.

All necessary cut-outs for heating elements, rollers, measuring points and inspection openings are already provided in the modules.

In each kiln zone there are different masonry materials, which are adapted to the respective temperature requirements.

SAFETY EQUIPMENT

The equipment complies with the following directives:

- EC Machinery Directive 2006/42/EC
- EC Electromagnetic Compatibility 2014/30/EU

TEMPERATURE CURVE OF KILN INSULATION

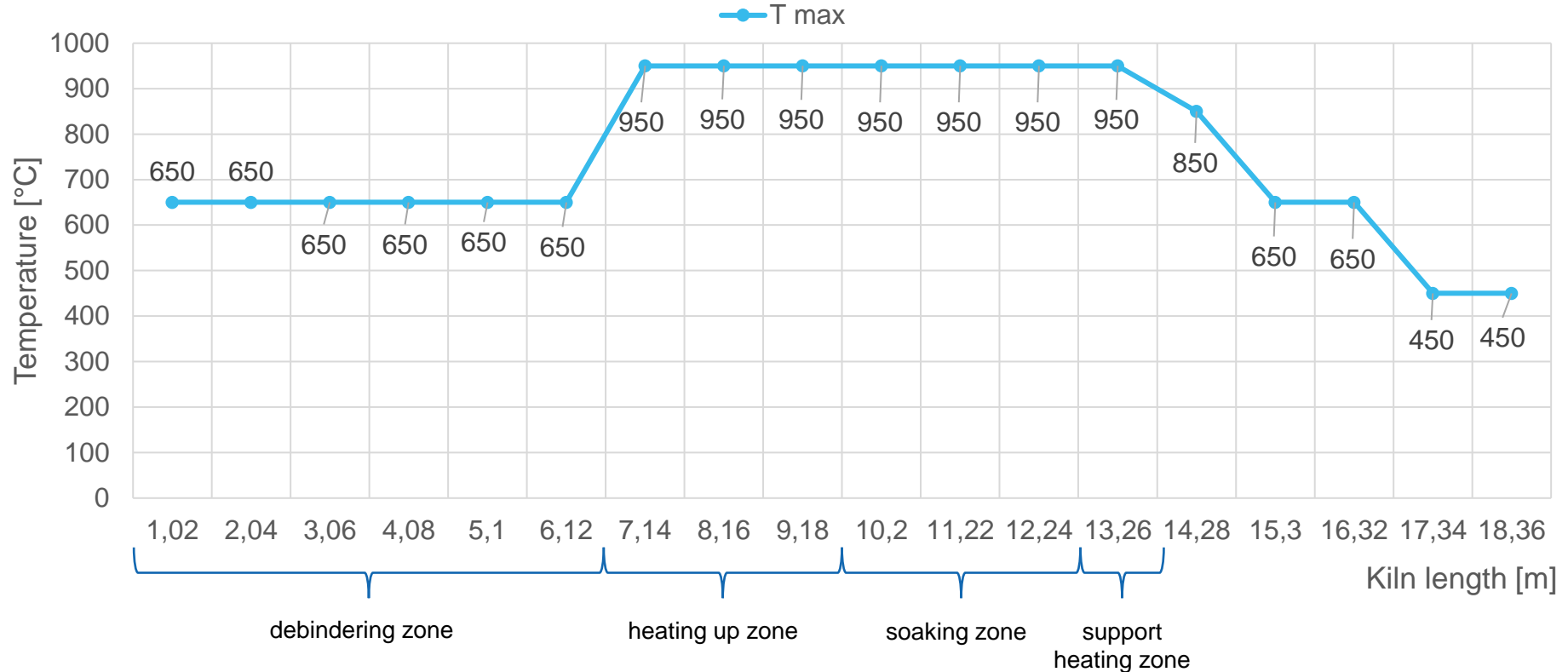

PHOTO-OVERVIEW

